

**vtech**<sup>®</sup>

User's Manual

# **SWITCH & GO DINOS**<sup>™</sup>

**SPAN THE SPINOSAURUS**<sup>™</sup>

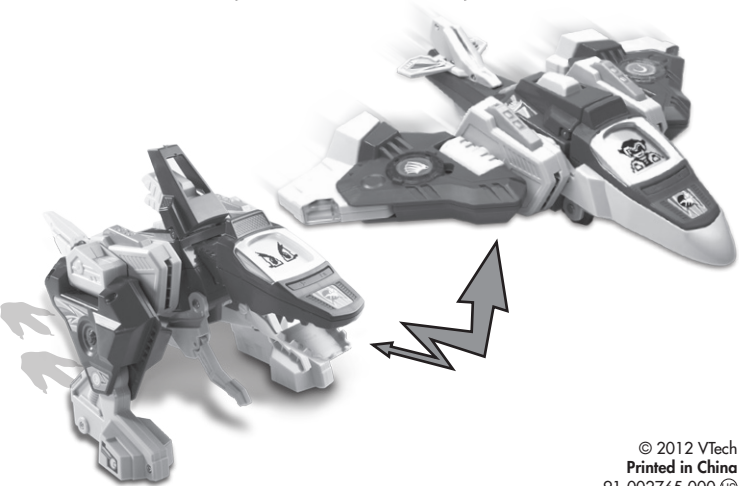

© 2012 VTech  
Printed in China  
91-002765-000 US



Hi Friend,

You're about to embark on a "dino-mite" adventure with me, **Span the Spinosaurus™**! Just so you know, I've been specially created just for you and am part of the **VTech® Switch & Go Dinos™** crew! **Switch & Go Dinos™** are a special breed of dinosaurs that transform from vehicle to dino in a few easy steps. You're going to love playing with me!

Not only can you help me do some wicked transformations, but you can help me do other cool things, too! Customize me by choosing my eyes in dino mode or picking a pilot when I'm in vehicle mode! Try pushing me on the ground or pressing a button and you'll hear me make awesome sounds! Press another button to hear me talk, and I'll tell you all about my wild life as a dinosaur! Maybe you'll even learn a thing or two.

For more fun, be sure to check out the rest of the **Switch & Go Dinos™** crew (each sold separately)! And remember, with me you're in for some dino switchin', high flyin' fun!

Your pal,

**Span the Spinosaurus™**

# INTRODUCTION

I'm **Span the Spinosaurus™**, and I'm the biggest carnivore of all time! My huge size, long jaws, and sharp teeth make me a meat-eating machine. And if that doesn't scare you, the massive sail on my back will! Let me give you some advice. When you see the sail, you better bail!

As a dinosaur I rule the land and the water, and as a plane I rule the skies! I can turn into a super-fast jet fighter and fly faster than the speed of sound! That means I'll be on top of you before you even hear me coming!

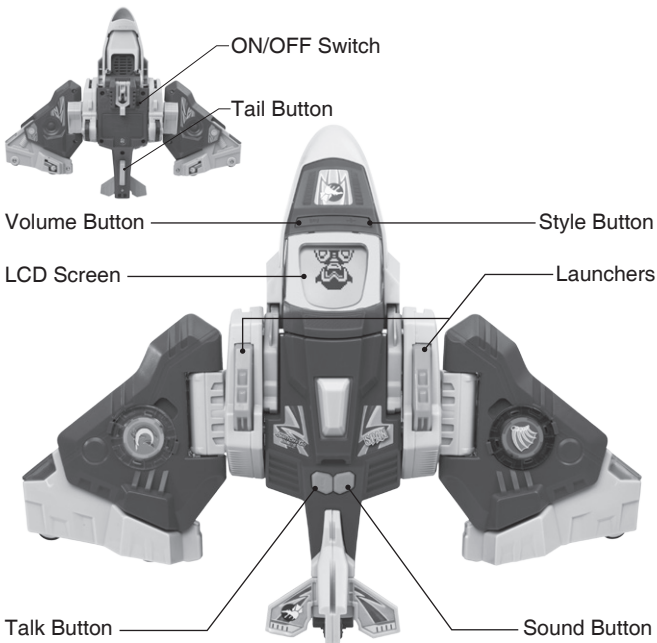

# INCLUDED IN THIS PACKAGE

- One VTech® SWITCH & GO DINOS™: Span the Spinosaurus™
- One user's manual

## WARNING:

All packing materials, such as tape, plastic sheets, packaging locks and tags are not part of this toy, and should be discarded for your child's safety.

## ATTENTION:

Pour la sécurité de votre enfant, débarrassez-vous de tous les produits d'emballage tels que rubans adhésifs, feuilles de plastique, attaches et étiquettes. Ils ne font pas partie du jouet.

## NOTE:

Please keep the user's manual as it contains important information.

# GETTING STARTED

## BATTERY INSTALLATION

1. Make sure the unit is turned **OFF**.
2. Locate the battery cover on the bottom of the unit. Use a screwdriver to loosen the screw.
3. Install 2 new "AA" (LR6/AM-3) batteries into the main unit following the diagram inside the battery box. (The use of new, alkaline batteries is recommended for maximum performance.)
4. Replace the battery cover and tighten the screw to secure.

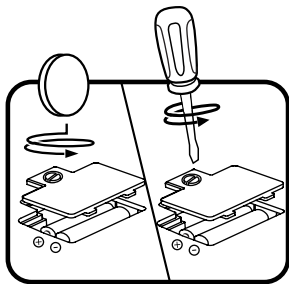

## BATTERY NOTICE

- Use new alkaline batteries for maximum performance.
- Use only batteries of the same or equivalent type as recommended.
- Do not mix different types of batteries: alkaline, standard (carbon-zinc) or rechargeable (Ni-Cd, Ni-MH), or new and used batteries.
- Do not use damaged batteries.
- Insert batteries with the correct polarity.
- Do not short-circuit the battery terminals.
- Remove exhausted batteries from the toy.
- Remove batteries during long periods of non-use.
- Do not dispose of batteries in fire.
- Do not charge non-rechargeable batteries.
- Remove rechargeable batteries from the toy before charging (if removable).
- Rechargeable batteries are only to be charged under adult supervision.

## PRODUCT FEATURES

### 1. TURNING THE UNIT ON

Slide the **ON/OFF Switch** to **ON** to turn the unit **ON**.

### 2. MOTION SENSOR

Move the plane to hear awesome flying sounds.



### 3. **STYLE BUTTON**

Press the **Style Button** to choose a pilot or change the dino eyes.



### 4. **TALK BUTTON**

Press the **Talk Button** to hear the dino or pilot talk.



### 5. **SOUND BUTTON**

Press the **Sound Button** to hear cool sound effects.

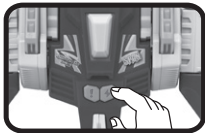

### 6. **VOLUME BUTTON**

Press the **Volume Button** to adjust the volume.



### 7. **TAIL BUTTON**

Press the **Tail Button** to make the dino chomp and roar.

Note: The dinosaur's head must be pulled all the way out in order for the Tail Button to work.

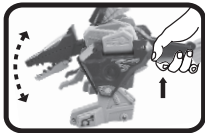

### 8. **FOOD DISCS**

Load the **Food Discs** into the launchers and press the buttons to watch them fly.



## 9. LAUNCHERS

Press the **Launchers** to launch the food discs.

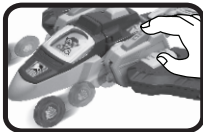

## 10. DINO CAGE AND BABY DINO

Press the button to open the **Dino Cage** and free the **Baby Dino**.

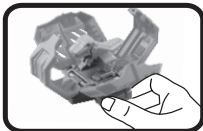

## 11. RESCUE LIFT

Use the **Rescue Lift** to carry the cage and other Switch & Go Dinos too.



## 12. REATTACHING THE DINO JAW

If the dinosaur jaw falls off, please follow the steps below to reattach it.

- 1) Turn the dinosaur upside down and insert the cylinder on the side of the jaw into the hole on the underside of the head.
- 2) Fit the holes on each side of the jaw over the blue knobs under the head.



## 13. TURNING THE UNIT OFF/ AUTOMATIC SHUT-OFF

Slide the **ON/OFF Switch** to **OFF** or hold the **Talk Button / Sound Button** for a few seconds to turn the unit **OFF**.

To preserve battery life, the unit will automatically power-off after several minutes without input.

## HOW TO SWITCH THE PLANE TO A DINO

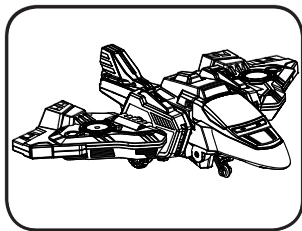

1. Plane shape.

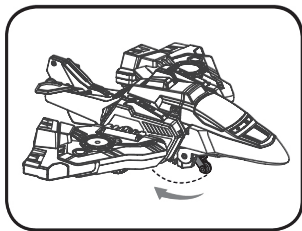

2. Move the landing gear on the bottom of the plane back.

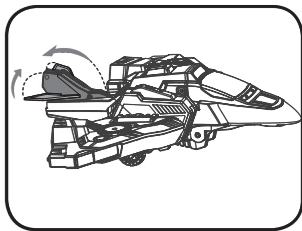

3. Move the sides of the tail in. Then move the whole tail down.

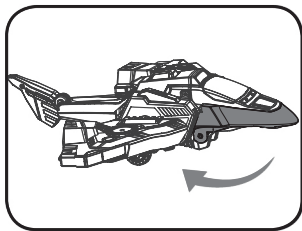

4. Rotate the nose of the plane down.

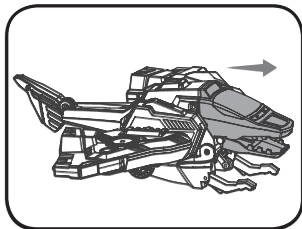

5. Pull the head out.

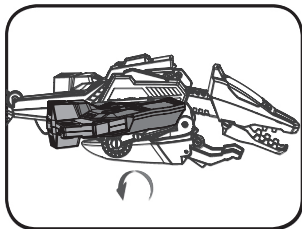

6. Rotate each of the wings 180 degrees so that they're facing backwards.



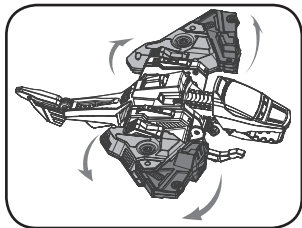

7. Flip each of the wings down and pull the feet down.

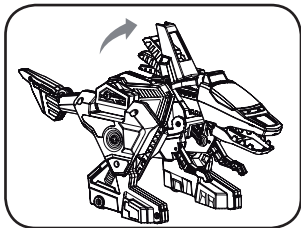

8. Move the spine up.

**Note:** To change the dino back into a plane, reverse the order of the steps above.

## CARE & MAINTENANCE

1. Keep the unit clean by wiping it with a slightly damp cloth.
2. Keep the unit out of direct sunlight and away from any direct heat source.
3. Remove the batteries when the unit is not in use for an extended period of time.
4. Do not drop the unit on a hard surface and do not expose the unit to moisture or water.

## TROUBLESHOOTING

If for some reason the unit stops working, please follow these steps:

1. Turn the unit **OFF**.
2. Interrupt the power supply by removing the batteries.
3. Let the unit stand for a few minutes, then replace the batteries.
4. Turn the unit **ON**. The unit should now be ready to play again.
5. If the product still does not work, replace with an entire set of new batteries.

If the problem persists, please call our Consumer Services Department at 1-800-521-2010 in the U.S. or 1-877-352-8697 in Canada, and a service representative will be happy to help you.

## NOTE:

FCC information: This equipment has been tested and found to comply with the limits for a Class B digital device, pursuant to Part 15 of the FCC Rules. These limits are designed to provide reasonable protection against harmful interference in a residential installation. This equipment generates, uses and can radiate radio frequency energy and, if not installed and used in accordance with the instructions, may cause harmful interference to radio communications. However, there is no guarantee that interference will not occur in a particular installation.

If this equipment does cause harmful interference to radio or television reception, which can be determined by turning the equipment off and on, the user is encouraged to try to correct the interference by one or more of the following measures:

- Reorient or relocate the receiving antenna.
- Increase the separation between the equipment and receiver.
- Connect the equipment into an outlet on a circuit different from that to which the receiver is connected.
- Consult the dealer or an experienced radio/TV technician for help.

**Caution:** changes or modifications not expressly approved by the party responsible for compliance could void the user's authority to operate the equipment.